

TENSION & COMPRESSION TYPE LOAD CELL

MODEL: **NTA**

Applications

- Crane Scale
- Belt Scale
- Tensile Testing
- Silo and Tank Weighing
- Industrial Scale
- Mechanical Conversion Kits

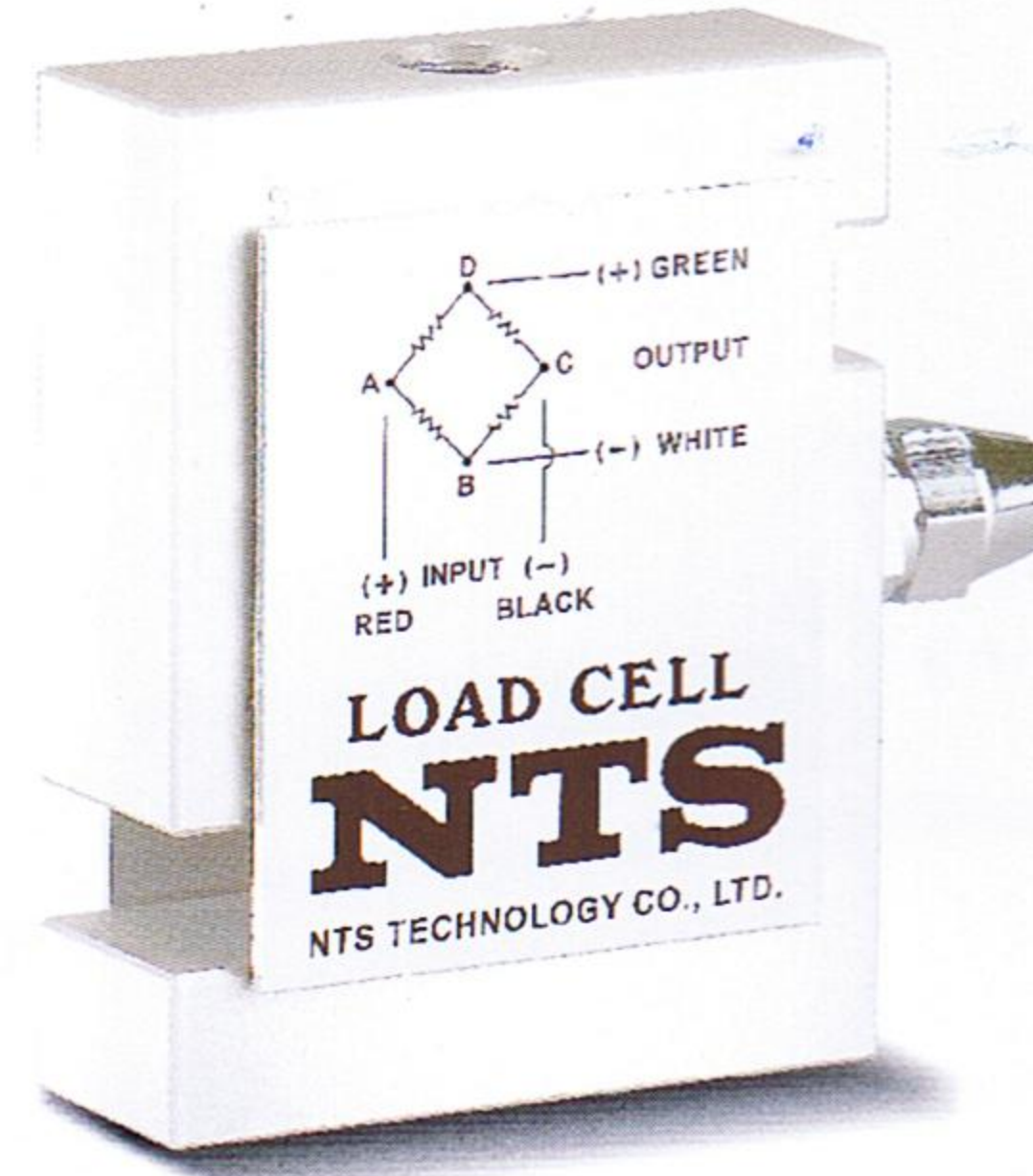

Outline

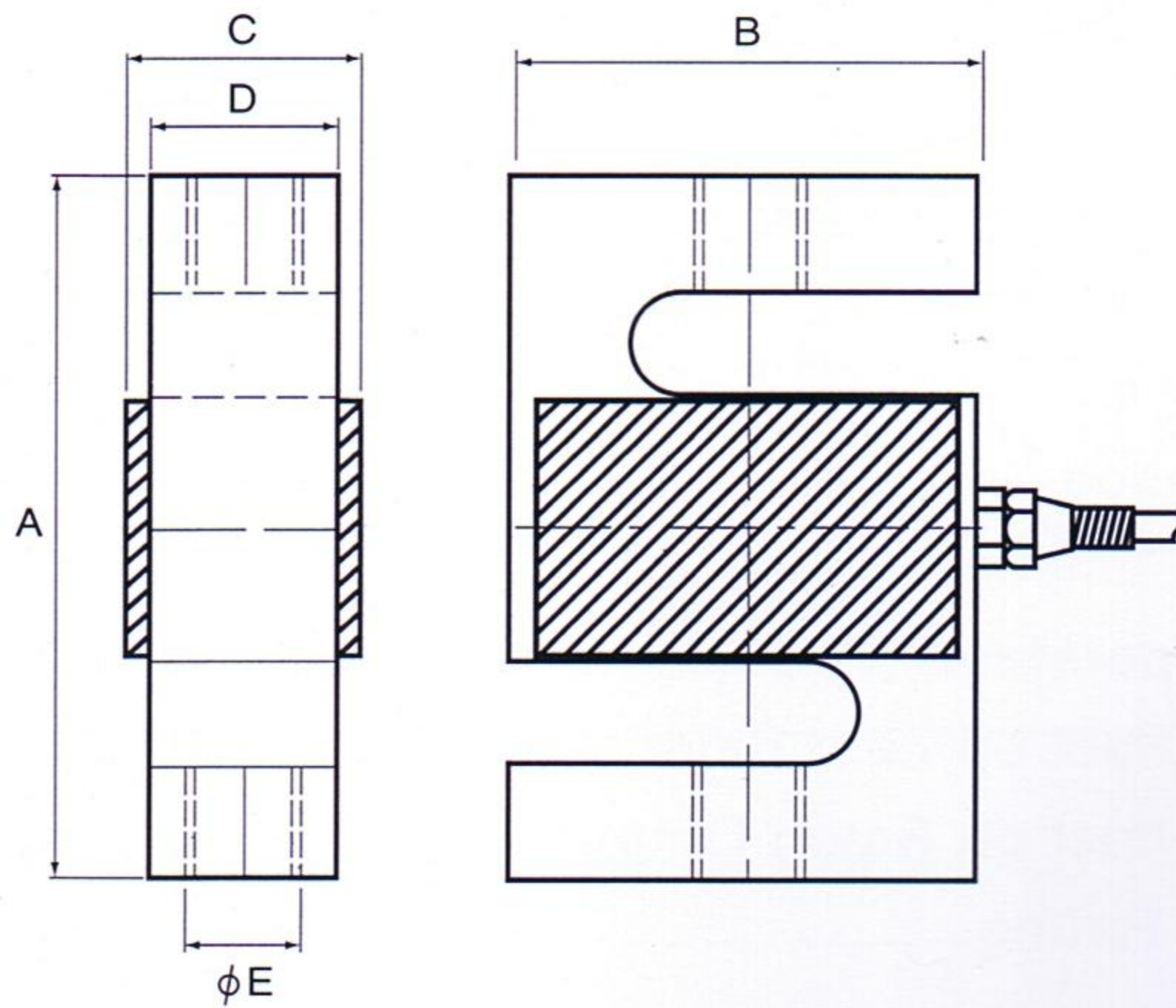

Standard Specifications

Rated Capacity.....	1KN~5KN
Rated Output.....	2±0.05mV/V
Zero Balance.....	±0.03%R.O.
Creep Error (20 minutes).....	±0.04%R.O.
Repeatability.....	±0.02%R.O.
Recommended Input Voltage.....	10V
Maximum Input Voltage.....	15V
Input Resistance.....	390±3Ω
Output Resistance.....	350±3Ω
Compensated Temperature Range.....	-10~+40 °C
Operating Temperature Range.....	-20~+60 °C
Temperature Effect on Zero Balance.....	±0.01%R.O./°C
Temperature Effect on Rated Output.....	±0.01%/°C
Safe Overload Rating.....	150%R.C.
Ultimate Load.....	200%R.C.
Material.....	Aluminum
Sealing.....	Complete hermetic sealing: cable entry sealed by metal header
Protection Class.....	IP 66
Cable.....	φ 6, 4-conductor shielded cable 4m long

Dimensions

MODEL	ITEM	RATED CAPACITY		A	B	C	D	φE
NTA-1KN		1KN	101.9kgf	76.2	50.8	24.4	20	M12
NTA-2.5KN		2.5KN	254.9kgf	82.0	64.0	27.4	23	M12
NTA-5KN		5KN	509.9kgf	82.0	64.0	27.4	23	M12

UNIT: mm