

MINIATURE COMPRESSION TYPE LOAD CELL

MODEL: **LCS**

Features

Miniature type load cell for low capacity force measurement. Possible to set at narrow space and suitable for measurement of force distributions of chair seat etc.



Outline

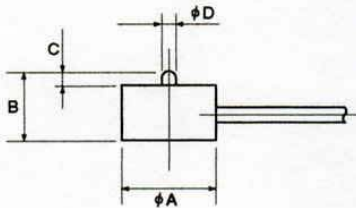

Standard Specifications

Rated Capacity.....	10N~1KN
Rated Output.....	1mV/V(10N~50N is 0.5mV/V)
Non-Linearity.....	0.5%R.O.
Hysteresis.....	0.5%R.O.
Recommended Input Voltage.....	5V
Maximum Input Voltage.....	10V
Input/Output Resistance.....	350Ω±1%
Safe Overload Rating.....	120%R.C.
Cable.....	φ3, 4-conductor shielded cable 5m long
Weight.....	75g

Dimensions

MODEL	ITEM	RATED CAPACITY	φA	B	φC	φD
LCS-10N		10N	16	12	2	2.5
LCS-20N		20N	16	12	2	2.5
LCS-50N		50N	16	12	2	2.5
LCS-100N		100N	20	11.5	2	2.5
LCS-200N		200N	20	11.5	2	2.5
LCS-500N		500N	20	11.5	2	2.5
LCS-1KN		1KN	20	11.5	2	2.5